

The Pacific Commercial Advertiser Issued Every Morning, Except Sunday, by the HAWAIIAN GAZETTE COMPANY, Von Holt Block, King Street.

C. G. BALLENTYNE, Manager.

SHIPPING INTELLIGENCE.

ARRIVALS.

Friday, May 13. C.-A. S. S. Warrimoo, Hay, from Vancouver and Victoria. Stmr. Mauna Loa, Simeron, from Maui and Hawaii ports. Ger. bk. J. C. Glade, Stege, from Liverpool. Stmr. James Makee, Tullett, from Kapaa. Stmr. Waialeale, Parker, from Oahu ports. Stmr. Maui, Freeman, from Hawaii and Maui. Stmr. J. A. Cummins, Searle, from Oahu ports. Stmr. Ke Au Hou, Thompson, from Lahaina.

DEPARTURES.

Friday, May 13. Stmr. Noeau, Pederson, for Kauai ports. Stmr. James Makee, Tullett, for Kapaa.

PASSENGERS.

Arrivals. From Vancouver and Victoria, per C.-A. S. S. Warrimoo, May 13—W. Duguid, Norman Kay, Mrs. H. Marsh, M. A. Harkins, W. Hilton, I. B. Rickard, A. B. Arleigh, Mrs. A. D. Wishard, Mrs. J. M. Smythe, Mrs. L. E. Arleigh, Miss T. B. Arleigh, L. Harrison, A. R. Smythe and 30 through. From Maui and Hawaii ports, per stmr. Mauna Loa, May 13—Right Rev. Roper, D. Conway, Dr. McWayne, Geo. Clark and daughter, Geo. McDougall, Sr., Geo. McDougall, Jr., W. B. Macfarlane, R. M. Keamohuli, Isaac Sherwood, J. K. Kaulia, Henry Peters and wife, Stephen Barrett and wife, W. H. Cornwell, G. Hons, Miss Lizzy Cockett, E. Kopke, wife and family and 72 on deck. From Oahu ports, per stmr. Waialeale, May 13—Mrs. Short and 3 on deck. Departures. For Kauai, per stmr. James Makee, May 13—Miss Juliette Smith, G. N. Wilcox and R. W. T. Purvis.

Cricket Match Today.

The cricket match this afternoon is expected to prove to be one of the best and most even played so far this season. It commences at 2 o'clock on the old baseball grounds and it is hoped that all players will be punctual in turning out and all those interested in the game will be in attendance.

H. L. Herbert's XI.—Rev. Mr. Lane and Messrs. Lightfoot, Hatfield, Vincent, Jordan, Langley Sloggett, Baird, White, Kinney, Dr. Murray and H. L. Herbert.

A. St. M. Mackintosh's XI.—Prince David, Messrs. Pliania, Harvey, Rev. V. H. Kiteat, D. Ross, Catton, S. P. Woods, Shanks, Judge Stanley, Dr. Weddick and A. St. M. Mackintosh.

Horse Racing Today.

At 2 o'clock this afternoon at Kapiolani Park track will begin the match race between Hollinger's Margaret H and Norton's Directress, harness horses well known here. The animals are quite evenly matched and betting is heavy. In figuring on the battle the drivers appear to be quite a factor. Gibson, driver of Creole and Irish Lassie, will be up behind Directress. He is now considered about the best driver here. This more particularly since "Dick" Davis retired. Bagsby, who now trains Violin, and who has done good work in many races here, will hold the lines over Margaret H. Bagsby is a man of judgment and experience and it is said he gained some useful new ideas while in the colonies lately. The race will be strictly on its merits and will be close.

Baseball.

The Honolulu baseball players still claim that their defeat by the Regents last Saturday was simply an off day Waterloo. The changes have been made in the Honolulu team. These are Mahuka at second in place of Koki and Luahiwa in place of Duncan. Game will be called at 3 o'clock. These are the men and positions: Honolulu—Dayton c, Lemon p, Willis 1b, Mahuka 2b, Luahiwa 3b, Thompson ss, Pryce lf, Kaanoi cf, Pahau rf. Regiment—Wilder c, Hart p, Davis 1b, Moore 2b, Bower 3b, Lishman ss, Kiley lf, Jones cf, Goman rf.

Sailor's Pilikia.

One of the Zealandia sailors has been arrested on the charge of desertion, and may be prosecuted for theft. It seems that on Thursday he took a horse and buggy belonging to George Riseley and sold it to Ah Hoy for \$10. When Riseley went home he found what was up and set out in search of his lost possessions. The Chinaman was found and he identified the sailor as the one who had committed the theft.

At San Francisco May 4th, Edna Wallace Hooper was granted a divorce from De Wolf Hopper.

WHARF AND WAVE.

DIAMOND HEAD SIGNAL STATION, May 13, 10 p. m.—The weather is clear; wind, light N.

The Santiago arrived in Hilo from San Francisco on Tuesday last. The James Makee and Noeau both sailed again for Kauai yesterday.

The Warrimoo sailed for the Colonies at an early hour this morning. The Waialeale came in from Oahu ports late Thursday night. She will not sail again until Monday.

The Archer will not sail for San Francisco until Tuesday. She will wait for the news of the war before leaving. Seven passengers, all the Archer can take, are now booked at Castle & Cooke's.

The James Makee which arrived yesterday morning reports the following sugar left on Kauai: Kilauea, 230 bags; Kapaa, 8,000; Hanamauhu, 1,000; Lihue, 600; Koloa, 1,500; Waimea, 7,000; Makaweli, 10,800.

The Warrimoo arrived in port early yesterday afternoon, after a very smart trip from Vancouver and Victoria. Purser Bellmaine kindly furnished the following report:

"The C.-A. S. S. Warrimoo, 3,200 tons, Chas. Wm. Hay commander, left Vancouver, B. C., at 3 a. m., May 6, and Victoria later on same day, having been delayed some 20 hours through Atlantic mail being late. Experienced moderate to fine weather with light winds to arrival at Honolulu at 2:30 p. m., 13th May, after a run down from Victoria of 7 days, 3 hours. Passed a barque flying Hawaiian colors towing in past Cape Flatery at 3 p. m., 6th May and R. M. S. Aorangi, at 4:30 p. m., 12th May, bound north, both wished to be reported 'all well.'"

The following constitutes the cargo of 190 tons brought by the Warrimoo: 250 drums cod fish, 65 bbls. herrings, 2 cs. dry goods, 6 cases machinery, 706 bbls. beer, 6 bbls. beer tonic, 457 bbls. bottled beer, 4 hrs. adv. matter, 21 bales compressed hay, 40 cs. lard, 3 cs. hams and bacon, 1 cs. books.

THE Oceanic Gas and Electric Co.

Having received a large consignment of gas apparatus and fixtures and a number of GRAPHOPHONES, with full assortment of RECORDS, beg leave to announce that the latter will be at the disposal of the public from 7:30 to 10 p. m. Records will be made in accordance with visitors' suggestions.

M. M. Kohn, Manager.

112 Hotel street. Corner Hotel and Union Streets.

MEETING NOTICE.

The regular quarterly meeting of the Union Feed Company, Ltd., will be held at the Company's office, on Saturday, May 14th, 1898, at ten o'clock a. m. F. R. VIDA, Secretary of the Union Feed Company, Ltd.

G. DIETZ, PRACTICAL WATCHMAKER Has Removed to 417 NUUANU STREET, (Next to Central Meat Market.) All Work Guaranteed. 35 Years' Experience.

HONOLULU MESSENGER SERVICE.

Cor. King and Alakea Sts. Honolulu, H. I. Messages and packages delivered to all parts of the city. Prompt service and reasonable charges. Office open until 12 o'clock p. m. Telephone 378. P. G. CAMARINOS, Manager.

Chocolate Bon Bons.

LEWIS & CO. Have received from Boston an invoice of the celebrated Walter M. Lowney Co.'s Chocolates—Souvenir, Pastilles, Frappe, Almond and Nugatines.

BICYCLE OIL.

It is a well known fact among mechanics in these Islands, that their light lubricating Oils are utterly useless here. They dry up or run out of the bearings: in fact you must use a far heavier oil here than in colder countries. Oil bottled in the United States for sewing machine use is of no use to lubricate a Bicycle. Bicycles here, do not, as a rule, get enough lubricant. Of twenty Bicycles overhauled on Monday in

The Honolulu Cyclery, 231 KING ST.,

Sixteen of them were absolutely dry. They needed. Bailey's Best Bicycle Oil Put up in tin cans, 25 cents each, which is just as cheap as light thin oil.

LOST TWO MEN.

German Bark Glade 166 Days From Liverpool.

The German bark J. C. Glade, Stege master, arrived in port yesterday morning after a very rough trip of 166 days from Liverpool. She comes consigned to H. Hackfeld & Co. and brings a cargo of 2,200 tons of general merchandise as well as a lot of pig iron. The Glade passed through storm after storm on her way from Liverpool. In the Bay of Biscay, two seamen, Frede and Jahne were washed overboard. Captain Stege would give no particulars in regard to the affair, preferring to allow as little as possible to be said about it in the newspapers. About a month was spent in the endeavor to beat around the Horn. The Glade is alongside the fishmarket wharf.

The Ke Au Hou arrived from Lahaina at 12:30 this morning with sugar.

Hawaiian Baseball Association BASEBALL SEASON. FIRST REGIMENT VS. HONOLULU.

Saturday, May 14.

Game called at 3:30 P.M. Admission 25c.

NORTH KONA BOARDING HOUSE AND SANITARIUM.

Situate on the beach at Kailua, N. Kona. Careful treatment for all medical and surgical cases. Board and Lodging at reasonable rates accorded to invalids and visitors. Associated with the beach house is a mountain residence (1,500 feet elevation) where visitors may have the benefit of a change of atmosphere. Terms, etc., on application. Medical attendant. Managers: MRS. MARY ATCHERLEY. Medical Attendant: DR. ATCHERLEY, M.R.C.S., L.R.C.P.

ELECTION NOTICE.

AT THE FIRST MEETING OF THE Oahu Market Company, Ltd., held in Honolulu on the 7th inst., the following officers were elected to serve for the ensuing year: John M. Sass, President; Chas. H. Atherton, Vice-President; A. C. Wall, Secretary; W. E. Wall, Treasurer; Thos. E. Wall, Auditor. The above officers constitute the Board of Directors. ALFRED C. WALL, Secretary.

NOTICE

IS HEREBY GIVEN THAT WE have this day revoked the power and authority of Mr. R. N. Boyd of Honolulu, to act for us in all matters. And also we have revoked and cancelled that Power of Attorney we gave him under date of May 9th, 1898. Also we shall not be responsible for any of his acts which he may undertake to do in our names and for us. MRS. M. KEAWEPOO. MR. D. KEAWEPOO. Honolulu, May 10th, 1898.

NOTICE

IS HEREBY GIVEN THAT MR. S. AHMI of Kamaole, Kula, Maui, will act for us in all matters under full power of attorney. MRS. M. KEAWEPOO. MR. D. KEAWEPOO. Honolulu, May 10th, 1898.

OAHU CEMETERY ASSOCIATION.

ALL OWNERS OF LOTS IN THE NUUANU VALLEY CEMETERY are urgently requested to attend a meeting of the Oahu Cemetery Association, to be held at the office of Bruce Cartwright, on WEDNESDAY, May 18th, at 10 o'clock a. m., for the purpose of the election of Trustees and other important business.

A full attendance is desired. W. M. GRAHAM, Secretary pro tem.

FOR SALE.

PRACTICALLY NEW HOUSEHOLD Furniture of three rooms and kitchen. Will sell at extremely low figure. Apply to

HARNESS SHOP.

Fort and King streets.

FOR SALE.

A FRESH COW, THOROUGHbred Jersey, with heifer calf at side. Also the finest lot of Horses ever landed. To be seen at residence of Hon. J. A. Cummins. HARRY J. AGNEW.

FOR SALE.

AN OLD VIOLIN—STRONG and rich tone. To be seen at the Hawaiian News Co.'s. A bargain for a professional.

FOUND.

LADY'S BLACK VELVET CAPE. Owner can have same by proving property and paying for this advertisement. Business Office, Hawaiian Gazette Co., Ltd.

Your Tax

for the coming year on baking powder will be very light if you buy Schilling's Best and use only one heaping teaspoonful to a quart of flour.

Oceanic Steamship Company.

TIME TABLE:

The Fine Passenger Steamers of This Line Will Arrive at and Leave This Port as Hereunder:

Table with columns: FROM SAN FRANCISCO, FOR SAN FRANCISCO, and ship names with dates.

In connection with the sailing of the above steamers, the Agents are prepared to issue, to intending passengers, coupon through tickets by any railroad from San Francisco, to all points in the United States, and from New York by any steamship line to all European ports.

Wm. G. IRWIN & Co. General Agents Oceanic S. S. Co.

Pacific Mail Steamship Co. Occidental & Oriental Steamship Co.

Steamers of the above companies will call at Honolulu and leave this port on or about the dates below mentioned.

Table with columns: FOR JAPAN AND CHINA, FOR SAN FRANCISCO, and ship names with dates.

For freight and passage and all general information, apply to

H. Hackfeld & Co., Ltd. AGENTS.

BRUCE WARING & Co.

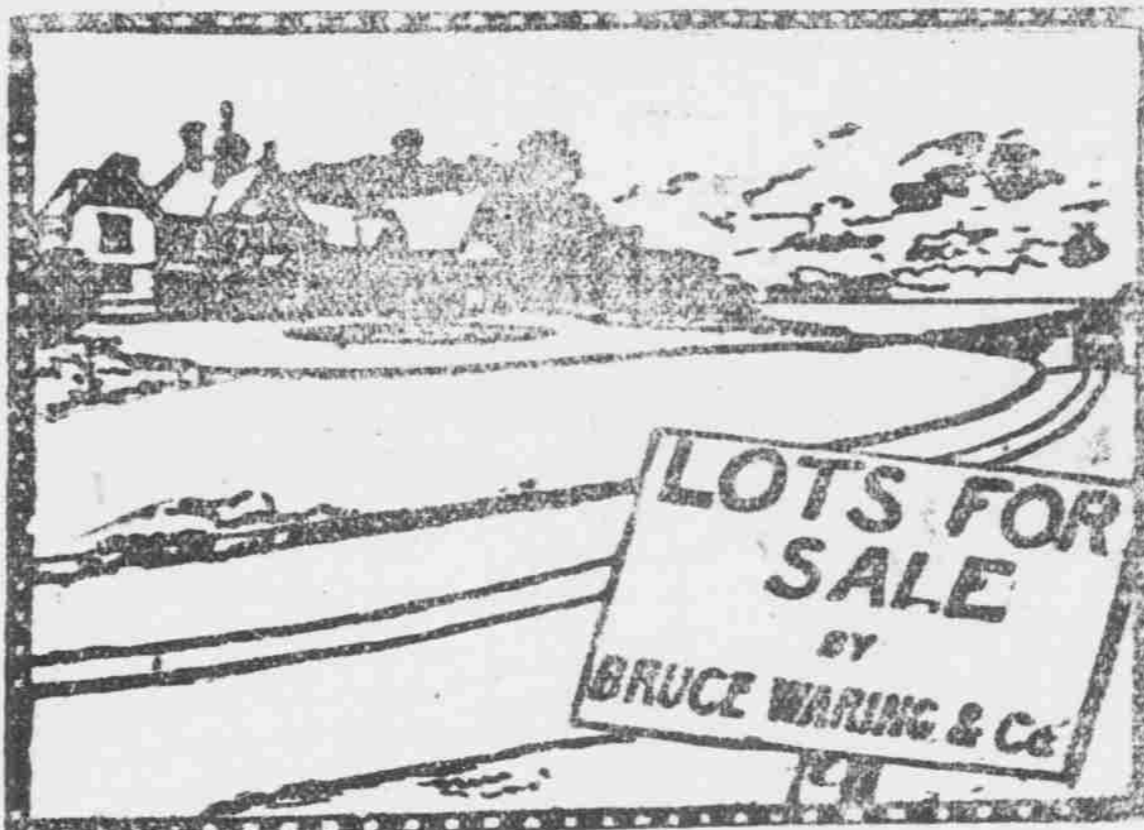

DEALERS IN Real Estate and Financial Agents.

Telephone 678. . . . 314 FORT STREET, HONOLULU. We are ready to purchase Large Estates near Honolulu and Hilo, and Coffee Lands on Hawaii. Loans placed and negotiated; Estates taken charge of and managed. Choice Lots for sale at Kewalo, at Punahou and the growing City of Hilo on the installment plan. Houses built for investors. No trouble to show property to intending purchasers.

J. M. MONSARRAT.

Attorney-at-Law, Real Estate and Financial Agent. SEARCHER OF RECORDS AND NOTARY PUBLIC. COMMISSIONER OF DEEDS FOR THE STATES OF NEW YORK AND CALIFORNIA. LOANS PLACED AND NEGOTIATED. Cartwright Block, Merchant Street. Telephone 68.

COFFEE LANDS for Sale or to Lease at Papa 2, Oelomoana 1, Kolo and Kaohi 4, in the celebrated Coffee District of Kona, Hawaii. These Lands will be sold or leased either large or small tracts to suit purchasers. Also:

FOR SALE.—Lands in Maui, Oahu and Molokai. FOR LEASE—1. A House and Lot at Waikiki. The house is partly furnished and contains seven rooms and a lanai, kitchen, pantry, two bath rooms, servant's room, Carriage House and Stables. Good sea bathing. These premises will be leased for a term of years at a reasonable rental. PASTURAGE at Kuliouou, Oahu.

Canadian-Australian Royal Mail Steamship Company.

Steamers of the above line, running in connection with the CANADIAN-PACIFIC RAILWAY COMPANY between Vancouver, B. C., and Sydney, N. S. W., and calling at Victoria, B. C., Honolulu, Suva (Fiji), and Wellington, N. Z., are

DUE AT HONOLULU

On or about the dates below stated, viz:

Table with columns: FROM VANCOUVER AND VICTORIA, B.C., FOR SUVA, WELLINGTON (N.Z.), and SYDNEY; and ship names with dates.

Through tickets issued from Honolulu to Canada, United States and Europe.

For Freight and Passage and all general information, apply to THEO. H. DAVIES & CO., Ltd., Gen. Agts.

CHAS. BREWER & CO.'S New York Line.

The Bark "Nuuanu" will sail from New York to Honolulu on or about July 15, 1898.

If sufficient inducement offers. Advances made on shipments on liberal terms. For further particulars, address Messrs. CHAS. BREWER & CO., 27 Kilby Street, Boston or C. BREWER & CO., LTD., Honolulu Agents.

FOR RENT.

Elegant Offices in the NEW PROGRESS BLOCK. Single or en suite.

Electric Elevator, Electric Lights; Lavatory and Sanitary arrangements complete.

Rooms ready for occupancy by the 15th of April.

For terms, inquire of BRUCE WARING & Co. 4859-tf 314 Fort Street.

Best Residence Lots For Sale.

There are only Eight Lots situated on mauka side of Beretania Street, and lying between Punchbowl Street and Miller Lane for sale. It is the only center premises for sale convenient for residences in market. Prices are very reasonable. For terms and further particulars apply to W. C. ACHI & CO., Real Estate Brokers. Honolulu, February 16th, 1898. 4845-tf

FOR LEASE.

For a long term of years, the desirable Pauoa pasture land, comprising about 400 acres. About 12 acres fenced; level land on good road, suitable for dairy houses and sorghum. The only ranch land adjoining Honolulu. Reasonable terms to responsible party. Inspection solicited. Inquire of

C. W. BOOTH, Tel. 494.

TANSAN

Is the Drink if You Want a Good MINERAL WATER. E. R. ADAMS, Agent Hawaiian Islands.

AT MRS. DICKSON'S OFFICE,

Woman's Exchange, you can have a good shampoo. Take your hair combings there to be made into a switch, your soiled Panama or straw hats, gloves, ribbons, etc., to be cleaned; also dresses, sponged and pressed.

FOR SALE.

California Horses.

MATCHED TEAMS, FAMILY HACK AND SADDLE HORSES. Orders Taken for All Classes of Horses.

STABLES, King St., Opp. Singer's Bakery J. A. McDONALD. P. O. Box 422.