

The Pacific Commercial Advertiser

Issued Every Morning, Except Sunday, by the HAWAIIAN-GAZETTE COMPANY, Von Holt Block, King Street.

C. G. BALLENTYNE, Manager.

TIDES, SUN AND MOON.

Table with columns for Day, Sun Rise, Sun Set, Moon Rise, Moon Set, High Tide, Low Tide. Includes data for Mon, Tues, Wed, Thurs, Fri, Sat, Sun.

The tides and moon phases are given in Standard time. The time of sun and moon rising and setting being given for all ports in the group are in Local time...

SHIPPING INTELLIGENCE.

ARRIVALS.

Saturday, May 14. Stmr. Iwalani, Gregory, from Hamakua. Stmr. Ke Au Hou, Thompson, from Lahaina...

DEPARTURES.

Saturday, May 14. Am. bk. C. D. Bryant, Colly, for San Francisco. C.-A. S. S. Warrimoo, Hay, for the Colonies.

VESSELS LEAVING TODAY.

Stmr. Kaena, Mosher, for Waialua ports at 12 m. Stmr. Waialeale, Parker, for Kahuku and Punaluu at 9 a. m. Stmr. James Makee, Tullet, for Kapaa at 4 p. m.

PASSENGERS.

Arrivals. From Honokaa, per stmr. Iwalani, May 14—A. Magee and 11 on deck. From Maui ports, per stmr. Claudine, May 15—F. B. Oat, Mrs. H. P. Baldwin, Mr. Castendyk, S. W. Kaal, E. S. Valentine, S. M. Dodge, Mrs. C. Y. Alina, Mrs. H. Higgins, Mrs. Kawamoto, Miss Kanaha, Mrs. Ah You, G. W. Smith and wife, Ting Kee, York Ting and 65 deck.

IMPORTS.

From Maui and Hawaii ports, per stmr. Mauna Loa, May 13—8,032 bags sugar, 22 bags coffee, 29 head cattle, 14 bds. hides, and 100 pkgs. sundries. From Kapaa, per stmr. James Makee, May 13—2,700 bags sugar for C. Brewer & Co.

WANTED.

BY DR. AUGER, A CENTRALLY located Cottage, suitable for family of three. Applications to Dr. G. J. Auger, Richards street, near Hawaiian Hotel.

Hawaiian Lodge No. 21, F. & A. M.

There will be a special meeting of Hawaiian Lodge, No. 21, F. & A. M., at its Hall, Masonic Temple, corner of Hotel and Alakea streets, THIS (Monday) EVENING, May 16, at 7:30 o'clock.

WORK IN SECOND DEGREE.

Members of Pacific Lodge, Lodge le Progres and all sojourning brethren are fraternally invited to attend. By order of the W. M. H. J. BURNISTON, Secretary.

FOREIGN NEWS NOTES.

An Italian decree has been gazetted suspending the duty on cereals until June 30. During bread riots at Sororina a mob attempted to set fire to the municipal buildings. The troops fired a volley into the crowd, killing two men and wounding several others.

The Honolulu Cyclery,

231 KING ST. Sixteen of them were absolutely dry. They needed. Bailey's Best Bicycle Oil Put up in tin cans, 25 cents each, which is just as cheap as light thin oil.

WHARF AND WAVE.

DIAMOND HEAD SIGNAL STATION, May 15, 19 p. m.—The weather is clear; wind, light, N.

The Ke Au Hou will go out tomorrow for Lahaina.

The Iwalani will go on the marine railway for slight repairs.

The ship A. J. Fuller took sugar at the Inter-island wharf on Saturday.

The Warrimoo did not get away until about 4:30 o'clock Saturday morning.

There are at present 15 foreign sailing vessels and one man-of-war in port.

The Archer and Western Monarch were loading sugar at the railroad wharf on Saturday.

A great many people are confidently expecting the Gaelic in from San Francisco tonight.

The schooner Emma and Louisa is loading up preparatory to her trip back to San Diego.

The James Makee which arrived Sunday reports the Noeua at Kahliliwal unloading freight. She had 330 bags of Kilauea sugar on Saturday.

Inspector Short has returned from his fortnight's vacation and is now on the night watch. Inspector Storey is now taking his turn at rest and recreation.

The Zealandia brought 1,300 tons of freight. This is her largest cargo on the run this time. The amount is more than the Australia had brought for several trips.

Butcher Hindal is with the Zealandia after making three trips to the north with the Australia. He says the Klondike route is the worst he ever traveled and that Skaguay is the most miserable hole of a town on earth, with Dyea reported the same.

The W. G. Hall arrived from Kaula, Sunday morning. The purser reports as follows: "Stmr. Kauai at Waimea. Had 3,000 bags of sugar at 4:45 p. m. Fine weather on Kaula. There were 135 bales of wool stored at Hanapapa warehouse on Niihau. Sugar left on Kaula was as follows: K. S. M., 4,200; V. R., 1,800; Makaweli, 6,500; G. & R., 1,500; K. P., 600; M. S. Co., 8,000. Total of 24,600 bags.

New Machinists.

Manager Hedemann of the Honolulu Iron Works has been fortunate in securing the services of Messrs. Turner, Verant, Keach, Kimball, Lacker and Morse, first-class machinists from San Francisco who arrived on the Zealandia to join Foreman W. E. Roe's working force. Manager Hedemann is congratulating himself as it is so hard to get first-class men in San Francisco on account of the excellent wages paid such men for work in the navy yard.

Made a Flying Fish.

A prominent physician of this city who not long ago went on Government business to Japan, tells a story on the chief officers of the Gaelic which cannot be doubted as it is relating to fish. The subject of flying fish happened to come up and one of the passengers expressed a wish to see one. The chief officer then went below and getting an ordinary fish put tail feathers and beautiful wings in the proper places so cleverly that the passenger "bit."

I have been a sufferer from chronic diarrhoea ever since the war and have used all kinds of medicines for it. At last I found one remedy that has been a success as a cure, and that is Chamberlain's Colic, Cholera and Diarrhoea Remedy.—P. E. Grisham, Gaars Mills, La. For sale by all Druggists and Dealers. Benson, Smith & Co., Ltd., Wholesale Agents for H. I.

OAHU CEMETERY ASSOCIATION.

ALL OWNERS OF LOTS IN THE Nuuanu Valley Cemetery are urgently requested to attend a meeting of the Oahu Cemetery Association, to be held at the office of Bruce Cartwright, on WEDNESDAY, May 18th, at 10 o'clock a. m., for the purpose of the election of Trustees and other important business.

FOR SALE.

PRACTICALLY NEW HOUSEHOLD Furniture of three rooms and kitchen. Will sell at extremely low figure. Apply to HARNES SHOP, Fort and King streets.

FOR SALE.

A FRESH COW, THOROUGHbred Jersey, with heifer calf at side. Also the finest lot of Horses ever landed. To be seen at residence of Hon. J. A. Cummins. HARRY J. AGNEV.

FOR SALE.

AN OLD VIOLIN—STRONG and rich tone. To be seen at the Hawaiian News Co.'s. A bargain for a professional. HARRY J. AGNEV.

FOUND.

LADY'S BLACK VELVET CAPE. Owner can have same by proving property and paying for this advertisement. Business Office, Hawaiian Gazette Co., Ltd.

Pilot House. The project of placing the new pilot house immediately on the Pacific Mail wharf has been abandoned, as the conditions were found to be unfavorable. It is proposed now to build pilot and boat houses entirely away from the Pacific Mail wharf and in the neighborhood of the entrance to the pier that leads to the King's boat house.

NORTH KONA BOARDING HOUSE AND SANITARIUM.

Situate on the beach at Kailua, N. Kona. Careful treatment for all medical and surgical cases. Board and Lodging at reasonable rates accorded to invalids and visitors. Associated with the beach house is a mountain residence (1,500 feet elevation) where visitors may have the benefit of a change of atmosphere. Terms, etc., on application. Medical attendant. Managers: MRS. MARY ATCHERLEY, Medical Attendant; DR. ATCHERLEY, M.R.C.S., L.R.C.P.

Chocolate Bon Bons.

LEWIS & CO. Have received from Boston an invoice of the celebrated Walter M. Lowney Co.'s Chocolates:—Souvenir, Pastilles Frappe, Almond and Nugatines.

HONOLULU MESSENGER SERVICE.

Cor. King and Alakea Sts. Honolulu, H. I. Messages and packages delivered to all parts of the city. Prompt service and reasonable charges. Office open until 12 o'clock p. m. Telephone 378. P. G. CAMARINOS, Manager.

G. DIETZ, PRACTICAL WATCHMAKER.

Has Removed to 417 NUUANU STREET, (Next to Central Meat Market.) All Work Guaranteed. 35 Years' Experience.

ELECTION NOTICE.

AT THE FIRST MEETING OF THE Oahu Market Company, Ltd., held in Honolulu on the 7th inst., the following officers were elected to serve for the ensuing year: John M. Sass, President; Chas. H. Atherton, Vice-President; A. C. Wall, Secretary; W. E. Wall, Treasurer; Thos. E. Wall, Auditor. The above officers constitute the Board of Directors. ALFRED C. WALL, Secretary.

NOTICE.

IS HEREBY GIVEN THAT WE have this day revoked the power and authority of Mr. R. N. Boyd of Honolulu, to act for us in all matters. And also we have revoked and cancelled that Power of Attorney we gave him under date of May 9th, 1898. Also we shall not be responsible for any of his acts which he may undertake to do in our names and for us. MRS. M. KEAWEPOO, MR. D. KEAWEPOO, Honolulu, May 10th, 1898.

NOTICE.

IS HEREBY GIVEN THAT MR. S. AHMI of Kamaole, Kula, Maui, will act for us in all matters under full power of attorney. MRS. M. KEAWEPOO, MR. D. KEAWEPOO, Honolulu, May 10th, 1898.

FOR SALE.

FOR SALE. A FRESH COW, THOROUGHbred Jersey, with heifer calf at side. Also the finest lot of Horses ever landed. To be seen at residence of Hon. J. A. Cummins. HARRY J. AGNEV.

FOR SALE.

FOR SALE. AN OLD VIOLIN—STRONG and rich tone. To be seen at the Hawaiian News Co.'s. A bargain for a professional. HARRY J. AGNEV.

FOR SALE.

FOR SALE. A FRESH COW, THOROUGHbred Jersey, with heifer calf at side. Also the finest lot of Horses ever landed. To be seen at residence of Hon. J. A. Cummins. HARRY J. AGNEV.

FOR SALE.

FOR SALE. AN OLD VIOLIN—STRONG and rich tone. To be seen at the Hawaiian News Co.'s. A bargain for a professional. HARRY J. AGNEV.

FOUND.

LADY'S BLACK VELVET CAPE. Owner can have same by proving property and paying for this advertisement. Business Office, Hawaiian Gazette Co., Ltd.

Clay

is put into "cheap" baking powder to fill up the can; alum to raise the dough. Alum is bad for the insides, but the manufacturer doesn't mean you any harm,—he just wants to get rich. San Francisco 602 A. Schilling & Company

Oceanic Steamship Company.

TIME TABLE:

The Fine Passenger Steamers of This Line Will Arrive at and Leave This Port as Hereunder:

Table with columns for FROM SAN FRANCISCO and FOR SAN FRANCISCO. Lists ships like MARIPOSA, ZEALANDIA, MOANA, ALAMEDA with dates.

In connection with the sailing of the above steamers, the Agents are prepared to issue, to intending passengers, coupon through tickets by any railroad from San Francisco, to all points in the United States, and from New York by any steamship line to all European ports.

Wm. G. IRWIN & Co. General Agents Oceanic S. S. Co.

Pacific Mail Steamship Co. Occidental & Oriental Steamship Co.

Steamers of the above companies will call at Honolulu and leave this port on or about the dates below mentioned.

Table with columns for FOR JAPAN AND CHINA and FOR SAN FRANCISCO. Lists ships like GAELIC, CITY OF PEKING, DORIC, CHINA, BELGIC, RIO DE JANEIRO, PERU, COPTIC, RIO DE JANEIRO with dates.

For freight and passage and all general information, apply to

H. Hackfeld & Co., Ltd. AGENTS.

BRUCE WARING & Co.

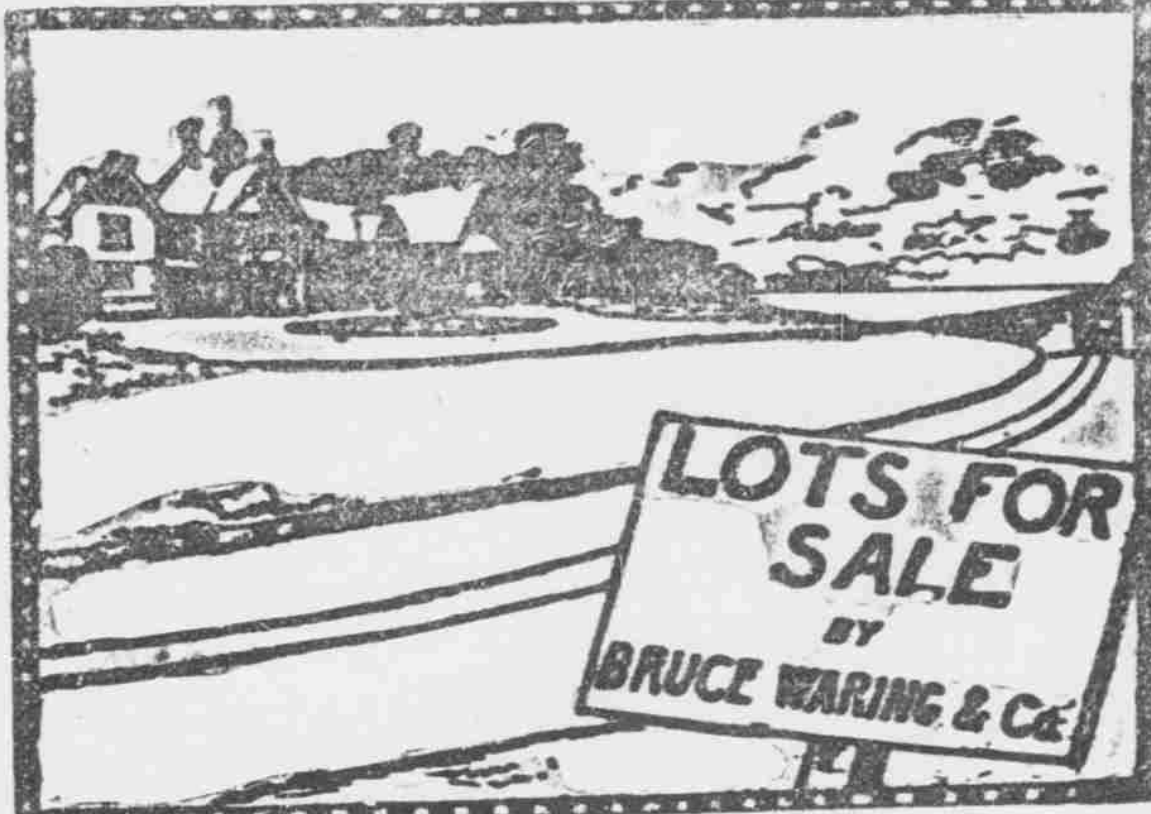

DEALERS IN Real Estate and Financial Agents.

Telephone 678. 314 FORT STREET, HONOLULU. We are ready to purchase Large Estates near Honolulu and Hilo, and Coffee Lands on Hawaii. Loans placed and negotiated; Estates taken charge of and managed. Choice Lots for sale at Kewalo, at Punahou and the growing City of Hilo on the installment plan. Houses built for investors. No trouble to show property to intending purchasers.

J. M. MONSARRAT. Attorney-at-Law, Real Estate and Financial Agent.

SEARCHER OF RECORDS AND NOTARY PUBLIC. COMMISSIONER OF DEEDS FOR THE STATES OF NEW YORK AND CALIFORNIA. LOANS PLACED AND NEGOTIATED. Cartwright Block, Merchant Street. Telephone 68.

COFFEE LANDS for Sale or to Lease at Papa 2, Oelolomoana 1, Kolo and Kaohae 4, in the celebrated Coffee District of Kona, Hawaii. These Lands will be sold or leased either large or small tracts to suit purchasers. Also: FOR SALE.—Lands in Maui, Oahu and Molokai. FOR LEASE.—1. A House and Lot at Waikiki. The house is partly furnished and contains seven rooms and a lanai, kitchen, pantry, two bath rooms, servant's room, Carriage House and Stables. Good sea bathing. These premises will be leased for a term of years at a reasonable rental. PASTURAGE at Kailouou, Oahu.

Canadian-Australian Royal Mail Steamship Company.

Steamers of the above line, running in connection with the CANADIAN-PACIFIC RAILWAY COMPANY between Vancouver, B. C., and Sydney, N. S. W., and calling at Victoria, B. C., Honolulu, Suva (Fiji), and Wellington, N. Z., are

DUE AT HONOLULU

On or about the dates below stated, viz:

Table with columns for FROM VANCOUVER AND VICTORIA, B.C. and FROM SYDNEY, WELLINGTON (N.Z.) & SUVA. Lists ships like AORANGI, MIOWERA, WARRIMOO with dates.

Through tickets issued from Honolulu to Canada, United States and Europe.

For Freight and Passage and all general information, apply to

THEO. H. DAVIES & Co., Ltd., Gen. Agts.

CHAS. BREWER & Co.'s New York Line.

The Bark "Nuuanu" will sail from New York to Honolulu on or about July 15, 1898.

It sufficient inducement offers. Advances made on shipments on liberal terms. For further particulars, address Messrs. CHAS. BREWER & CO., 27 Kilby Street, Boston or C. BREWER & CO., LTD., Honolulu Agents.

FOR RENT.

Elegant Offices in the NEW PROGRESS BLOCK. Single or en suite.

Electric Elevator, Electric Lights; Lavatory and Sanitary arrangements complete.

Rooms ready for occupancy by the 15th of April.

For terms, inquire of

BRUCE WARING & Co.

4859-1st 314 Fort Street.

Best Residence Lots For Sale.

There are only Eight Lots situated on mauka side of Beretania Street, and lying between Punchbowl Street and Miller Lane for sale. It is the only center premises for sale convenient for residences in market. Prices are very reasonable. For terms and further particulars apply to W. C. ACHI & CO., Real Estate Brokers. Honolulu, February 16th, 1898. 4845-1st

FOR LEASE.

For a long term of years, the desirable Paoua pasture land, comprising about 400 acres. About 12 acres fenced; level land on good road, suitable for dairy houses and sorghum. The only ranch land adjoining Honolulu. Reasonable terms to responsible party. Inspection solicited. Inquire of C. W. BOOTH, Tel. 494.

TANSAN

Is the Drink if You Want a Good MINERAL WATER. E. R. ADAMS, Agent Hawaiian Islands.

AT MRS. DICKSON'S OFFICE,

Woman's Exchange, you can have a good shampoo. Take your hair combs there to be made into a switch, your soiled Panama or straw hats, gloves, ribbons, etc. to be cleaned; also dresses, sponged and pressed.

FOR SALE.

California Horses.

MATCHED TEAMS. FAMILY HACK AND SADDLE HORSES. Orders Taken for All Classes of Horses.

STABLES, King St., Opp. Singer's Bakery.

J. A. McDONALD. P. O. Box 422.